



71301001 HATCH SEAL "TRIM-LOC"
(TOP MOLDED) 5' REQ

71302001 HULL FLANGE SEAL (PRE 2012 ADV)
"TRIM-LOC" (SIDE GLUED) 5' REQ

71220001 METAL PAD EYE
8030071 SCREW

76050001 BOW/ STERN HANDLE

72542001 DOME STICKER 1.75"

72104001 HOOK

80012001 PEDAL RETAINER BUNGEE w/ HOOK

78560001 MESH STOWAGE POCKET
8031501 SCREW

84560001 MAST RECEIVER COVER
8031151 SCREW

84550001 MAST RECEIVER

SEE MIRAGEDRIVE PAGE
FOR DRIVE DETAILS

38120031 PUSH-IN CAP (White)
(Underside Of Hull)

74075001 PADDLE 2-PEICE FIBER SHAFT
(Only sold as matched set)



74010001 REPLACEMENT BLADE RIGHT
74011001 REPLACEMENT BLADE LEFT

74030002 DRIP RING FG SHAFT
74030001 DRIP RING ALUM SHAFT

74076101 BUTTON PLASTIC
74076102 BUTTON SS

74049001 PADDLE "T" HANDLE



10730000 CLEAT
8030111 SCREW

72103001 SHOCKCORD END
8031130 SCREW



81535001 MIRAGE CASSETTE PLUG

WATER BOTTLE GUIDE

71999011 SMALL BOTTLE 16 Oz.
(Sport/Outback/Quest/Kona/Pro A)

71997001 MEDIUM BOTTLE 20 Oz.
(Odyssey/Lanai/Maui/Quest 13 (2013+))

71998001 LARGE BOTTLE 32 Oz.
(Revolution/Adventure/Adventure Island/
Outfitter/Oasis)



8031570 SCREW / PADDLE KEEPER BUNGEE
79538201 WEB PULL TAB



81611101 CLICK AND GO ASSY (L)
81611201 CLICK AND GO ASSY (R)

8030791 SCREW
(REQUIRES 3/16" allen "BALL-END" wrench)

81602101 SPRING CLICK AND GO LEFT
81602201 SPRING CLICK AND GO RIGHT



2008 AND OLDER
81410001 CAM LOCK KNOB
BOLTS VARY BY MODEL

RUDDER - UP / DOWN

8004531 LINE (BLK)
81450001 HOBIE CHEEK BLOCK
8031065 10-32 X 7/8 SCREW
8031069 10-32 X 1-1/4 SCREW (AI)
8050211 NUT



81408101 HANDLE
81406101 INSERT - UP
81407101 INSERT - DOWN



81408001 OLDER HANDLE
81406001 OLDER DECAL - UP
81407001 OLDER DECAL - DOWN



10730021 CLEAT STBD
10730031 CLEAT PORT
8031541 SCREW

OLDER UP / DOWN



81392001 TWIST AND STOW CONTROL ARM UP/DOWN
81380001 OLDER - CONTROL ARM UP/DOWN
81375001 SPRING
8080691 NYLON WASHER
81035011 BOLTED HANDLE AND CONTROL ARM KIT



81035001 UP / DOWN HANDLE
w/ SET-SCREW

RUDDER - STEERING

STEERING CRANKS
81014001 SPORT/REV 11
81016001 REV 13 / OB
81017001 OUTFIT / OASIS
88991281 CRANK - AI 2011+/TI



STEERING
81013001 STEERING HANDLE
8030126 SCREW
88991152 STICKER
81385001 WASHER
88991235 PIN
H071 SPRING



88991355 KNOB ASSY
(Handle Not Included)

OLDER STEERING



81015001 STEERING HANDLE
w/ SET-SCREW



81370001 CRANK
81372001 CRANK AI-OUTFIT
H071 SPRING
8080691 NYLON WASHER

MIRAGE SERIES SEAT

- 81269001 MIRAGE BACKREST - TWIST LOCK
- 81268001 MIRAGE BACKREST - EXPAND PEG
- 81259001 SEAT STRAP w/ HOOK



- 81277001 HANDLE
- 81245001 ROLL PIN
- 81276001 TWIST-LOC

81276201 TWIST-LOC SEAT KIT (PAIR)
(Fit Older Seat Into Twist Loc Hull)

81275001 TWIST-LOC RECEIVER* (IN HULL)
* REPLACEMENT PART ONLY - NOT RECOMMENDED AS AN UPGRADE



- 71190001 WEBBING LIFT HANDLE (PLASTIC END)
- 71190000 WEBBING LIFT HANDLE (WEB WITH HOLE)
- 8032011 SCREW
- 8080571 WASHER



- 76055001 MIDSHIP HANDLE
- 8032011 SCREW



- 88991061 MIDSHIP HANDLE
- 8032011 SCREW



OLDER SEAT PEGS



- 81265101 SEATBACK ADJUSTABLE PLUG KIT (PR)



- 81265001 SEATBACK PLUG
- 8031130 SCREW
- 8080541 WASHER

PADDLE SERIES SEAT



- 72402001 SEATBACK / PADDLE MODELS 2010
- 72409001 SEAT STRAP W/HOOK



- 10092030 PLUG
(Seat area of Adventure, Kona, Outfitter, Revolution)



- 72009001 SCUPPER PLUG
(Pursuit/ Maui/ Lanai)



- 72010 SCUPPER PLUG (Odyssey)



41220001 EYELET POST
8031131 SCREW



53180011 3/8" HOG RING
21180000 1/2" HOG RING



78520001 EYELET HOLD DOWN
8032121 SCREW

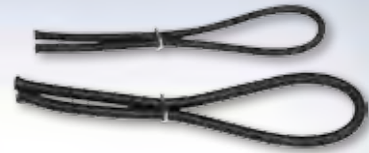

RS316BLK 3/16" SHOCKCORD
RS014BLK 1/4" SHOCKCORD
79538201 WEB PULL TAB



71110001 PADEYE
8030031 SCREW
8012001 RIVET



71120001 LASHING HOOK
8030031 SCREW



78510001 BUNGEE HOOK
8031961 SCREW



2101 SHOCKCORD FASTENER, 1/4"



71230001 ROD HOLDER COVER
8031131 SCREW



72012001 SCUPPER PLUG
(Quest / Kona / Outback)

HATCHES



71130001 HATCH 5" SCREW-IN
8031501 SCREW



71701011 HATCH 6" TWIST AND SEAL
71701001 HATCH 6" TWIST AND SEAL RETRO KIT
71321001 FLANGE GASKET / 71701021 LID O-RING
8031131 SCREW



71702011 HATCH 8" TWIST AND SEAL
71702001 HATCH 8" TWIST AND SEAL RETRO KIT
71331001 FLANGE GASKET / 71702021 LID O-RING
8031131 SCREW

TECH TIP!

DECK FASTENERS - Customize your boat with the fasteners of your choice... where you want them. The Hobie screw-in fittings can be easily removed and replaced. Add an extra eye where we placed a hook, a cleat hook where a shockcord end is placed... You choose what works best for you. Use tool #71115101

SCREW-IN FITTINGS



71116001 PADEYE



71117001 CLEAT



71115001 SHOCKCORD END



71115101 TOOL SCREW IN FITTINGS

TECH TIP!

MAINTENANCE AND TUNING - Maintenance and tuning information for Twist and Stow rudder systems is available on the Hobie Cat website support area.
<http://www.hobiecat.com/support/history/>

Direct link to the support pages for kayaks is here:
<http://www.hobiecat.com/support/products/kayaks/>



10091000 DRAIN PLUG W/ O-RING
 10092025 O-RING

79050211 DRAIN PLUG W/ O-RING
 79050212 O-RING

81391011 GUDGEON
 8030214 SCREW (2)

81394001 RUDDER PIN

81394021 RUDDER PIN 2011 CENTERLINE
 STYLE REQUIRES MODIFIED HOUSING

71280001 KEEL GUARD LANAI, KONA, QUEST, ODYSSEY
 8030231 SCREW (2)

TWIST AND STOW RUDDER

LINE AND TUBE ASSEMBLY
 80025001 (1)
 80020001 UNIVERSAL LINE
 REPLACEMENT KIT
 (SET OF 4 AND ADDITIONAL LINE)



81023001 SPECTRA CONTROL LINE
 8063001 SWEDGE
 81400001 TUBING
 81405001 TUBE HOLDER
 81405101 END CAP

8080791 WASHER

8030641 SCREW

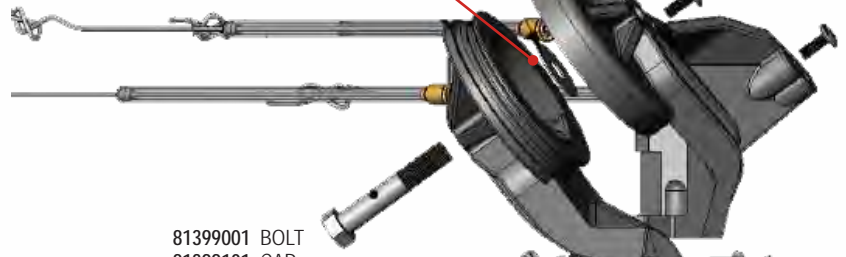

81399001 BOLT
 81399101 CAP

8050211 NUT

TWIST AND STOW
 RUDDER ASSEMBLY
 81395001 SM BLADE
 81396001 LG BLADE

8030281 SCREW

EARLY RUDDER PARTS

NYLON RUDDER PIN

81361001 CLASSIC
 81362001 OLDER OUTBACK
 81362001 OLDER SPORT
 81362001 OLDER TANDEM
 20860000 LOCK RING

81360001 S.S. RUDDER PIN

8030171 SCREW
 8080541 WASHER

81350001
 RUDDER MOUNT

81390001 RUDDER BLADE

RUDDER BLADE
 81395201 SM
 81397001 LG

QUEST

QUEST TWIST AND STOW RUDDER KIT
78501 QUEST 13
78502 QUEST 11



37380001 CLAM CLEAT



61070000 CLEAT
8031131 SCREW

8" HATCH

78540001 TRACK / FOOT BRACE
78535001 FOOT BRACE / LEFT
78536001 FOOT BRACE / RIGHT

MIRAGE CLASSIC



MIRAGE CLASSIC & PURSUIT
71201 CARGO COVER
71301001 LOC SEAL, 6.5FT

91281000 DRAIN SCREW

HOBIE MIRAGE i - SERIES

79050214 SCUPPER PLUG
79052007 SEATBACK / i-SERIES

79050061 i-SERIES CASSETTE PLUG
79050021 CLICK and GO SPRING

71702011 HATCH 8" TWIST AND SEAL
71331001 FLANGE GASKET
71702021 LID O-RING
8031130 SCREW

79052017 VALVE ASSY



81394001 RUDDER PIN
81395201 SMALL RUDDER BLADE
81395001 RUDDER ASSY. W/ SM. BLADE

76050001 BOW / STERN HANDLE

79050211 DRAIN PLUG W/ O-RING

79052019 PADDLE HOLDER

74077001 PADDLE 4 PC ALUMINUM SHAFT

80012001 PEDAL RETAINER BUNGEE w/ HOOK



79052000 i - ACCESSORY HOLDER KIT
Designed to allow the attachment of rod holders and other accessories to the Hobie Mirage inflatable kayaks. The accessory kit comes with 2 mount plates and attachment glue. 4 hole pattern fits Scotty mount and RAM / Scotty hole pattern products. Mount the 80052001 Scotty Deck/Side mount and Scotty rod holders or adapt for the RAM products by adding RAM Wedge Mounts 72023015 or 72023016. (1/4-20 Screws sold separately, check length for desired accessory / #8030380 7/8" length for Scotty deck mount).

79052006 i - HARDWARE ACCESSORY KIT
Includes padeyes, spare cleats and glue. Customize your Hobie inflatable.

79052001 i - CUP HOLDER KIT
Includes 2 flexible can / cup holders and glue. Customize your Hobie inflatable.

80045101 i - KAYAK CART "PLUG-IN"

79052015 i - TRI RING KIT / SAGE

79052016 i - TRI RING KIT / SUNDANCE

Includes 2 "Tri" rings mounted on round patches ready for installation. Customize.

79052009 i - HULL REPAIR KIT
Includes 2 colors of repair vinyl and glue, valve tool and instructions. Repair or customize a Hobie Mirage Inflatable kayak.

79052005 i - ELECTRIC INFLATION PUMP
Electric pump connects to car 12v outlet. Quickly and easily fill your Hobie inflatable. This is a high volume / low pressure pump. Use the standard pump to bring chambers to full pressure.

79052003 i - STANDARD INFLATION PUMP
Standard hand pump for Hobie inflatable.

79052010 i - 12 TRAVEL BAG
79052011 i - 14 TRAVEL BAG
79052012 i - 9 TRAVEL BAG