



PEDAL PAD KIT

Softer on your feet! Neoprene pads are self adhesive and stick right to your pedals. Stock on Drives built in 2010+
 72020034 PEDAL PAD KIT BLACK (PAIR)



DRIVE WELL SEAL

Keeps the seat area drier. Seals the aft end of the MirageDrive well. Limits the incursion of water into the cockpit caused by the surge action of the drive fins. Testers also claim some improvement of forward thrust. Easily attaches to older MirageDrive spines (pre-2013). Kit includes one seal and two attachment "zip ties".
 81037001 WELL SEAL
 81038001 i - WELL SEAL



Hobie MirageDrive GT shown

HOBIE MIRAGE SPEEDO

Removable, "pitot tube" speedometer measures your pedaling speed. Fits MirageDrive systems with plastic spine on drive serial number 16054 - Winter 2013 production. Latest version spines are not compatible.
 80030001 SPEEDO



HOBIE MIRAGEDRIVE "GLIDE TECHNOLOGY"

- 80010501 MIRAGE DRIVE GT - ST FINS
- 80013501 MIRAGE DRIVE GTi - ST FINS ISERIES
- 80012501 MIRAGE DRIVE GTT - ST TURBO FINS



LEASH KIT - MIRAGEDRIVE

If you ever remove your MirageDrive while on the water... protect your investment from an accidental drop overboard. Includes hardware for attachment to the hull.
 74052101 LEASH KIT - MIRAGEDRIVE

MIRAGEDRIVE STOW BAG

Protect your MirageDrive... and other goods in your car from the drive! This heavy duty Cordura and mesh bag fits the complete MirageDrive with standard fins or the ST Turbo length. It has small pockets inside for the speedo tube, scupper plugs or spare parts. Has a carry handle and a shoulder carry strap. There is extra space in the bag for things like a life vest or drive well plug. Also includes "D" ring fittings to allow attachment to Inflatable rolling bags. Large enough to store your Inflatable's drive, pump and 4 piece paddle.
 80024 MIRAGEDRIVE BAG



Now you can make your Hobie MirageDrive a SUPER PERFORMER!

PERFORMANCE FINS - ST OR ST TURBO!

The Hobie MirageDrive is the most amazing propulsion system ever seen! But there is more!

Increase your performance or increase your fitness routine, you choose the fin that is right for you: Standard, ST or ST Turbo... low, medium or a higher gear! The standard fins, supplied with our kayaks prior to 2015, are the easiest pedaling fins, but some users feel that the standard fins do not offer enough resistance. ST became standard equipment in 2015 models. This is very evident when using a sailing kit. The added power and speed of the sail often outpaces the standard or even ST fins (similar to pedaling a bike down hill in first gear).

Want to go really fast? Add ST TURBOS. Hobie Mirage kayak users report as much as 10% increase in speed and more using ST TURBO Fins. But its not all about speed, you can get top end speed and a slower cadence for cruising (Less pedals per mile). All achieved with these larger and more efficient fin designs. These longer fins can also increase lateral resistance for sailing upwind.

The ST (Square Tip) designs will require a bit more effort to pedal. The added effort is commonly compared to pedaling a bike up a slight incline. In addition, the included fin tension screw allows adjustment to achieve lower end torque or top end speed to meet the desires of the pedaler.

ST TURBO FINS & KITS

Kits come with 2 fins & 2 longer masts (available for V1 or V2 drives)

- 72066001 ST TURBO FIN KIT V2/GT - GRY/BLK (Threaded Sprocket)
- 72066021 ST TURBO FIN KIT V2/GT - RED/BLK (Threaded Sprocket)
- 72066031 ST TURBO FIN KIT V2/GT - BLU/BLK (Threaded Sprocket)
- 72065 ST TURBO FIN KIT (Older SS & Set-screw Sprocket)

- 81192001 ST TURBO FIN - GRY/BLK Single (replacement)
- 81192021 ST TURBO FIN - RED/BLK Single (replacement)
- 81192031 ST TURBO FIN - BLU/BLK Single (replacement)

ST FINS *fit any Standard Hobie MirageDrive*

- 81193001 ST FIN / SINGLE - GRY/BLK Single (replacement)
- 81193021 ST FIN / SINGLE - RED/BLK Single (replacement)
- 81193031 ST FIN / SINGLE - BLU/BLK Single (replacement)



MIRAGEDRIVE SPARE PARTS KITS V2 / GT

Spare parts kits include a fin, mast, sprocket, chain and appropriate parts for the drive version. V2 drives use threaded sprockets and masts. GT has roller bearings. All in a handy zippered pouch. Don't waste a day on the water when your MirageDrive could be easily repaired. Available for the Comfort / ST fin length masts or drives with ST Turbo fins. Comfort fin kit shown.

- 80010301 V2 COMFORT (Threaded Sprocket)
- 80010401 GT ST (Threaded/Bearing Sprocket)

- 80013301 V2 TURBO (Threaded Sprocket)
- 80013401 GT TURBO (Threaded/Bearing Sprocket)



HOBIE MIRAGEDRIVE "GLIDE TECHNOLOGY"

- 80010501 MIRAGE DRIVE GT - ST FINS
- 80013501 MIRAGE DRIVE GTi - ST FINS ISERIES
- 80012501 MIRAGE DRIVE GTT - ST TURBO FINS

TECH TIP!

WHAT MAKES A V2 DRIVE? V2 Drums, V2 Chains, V2 Idler Cable and V2 (Threaded) masts / sprockets (USED IN 2009 production and newer)

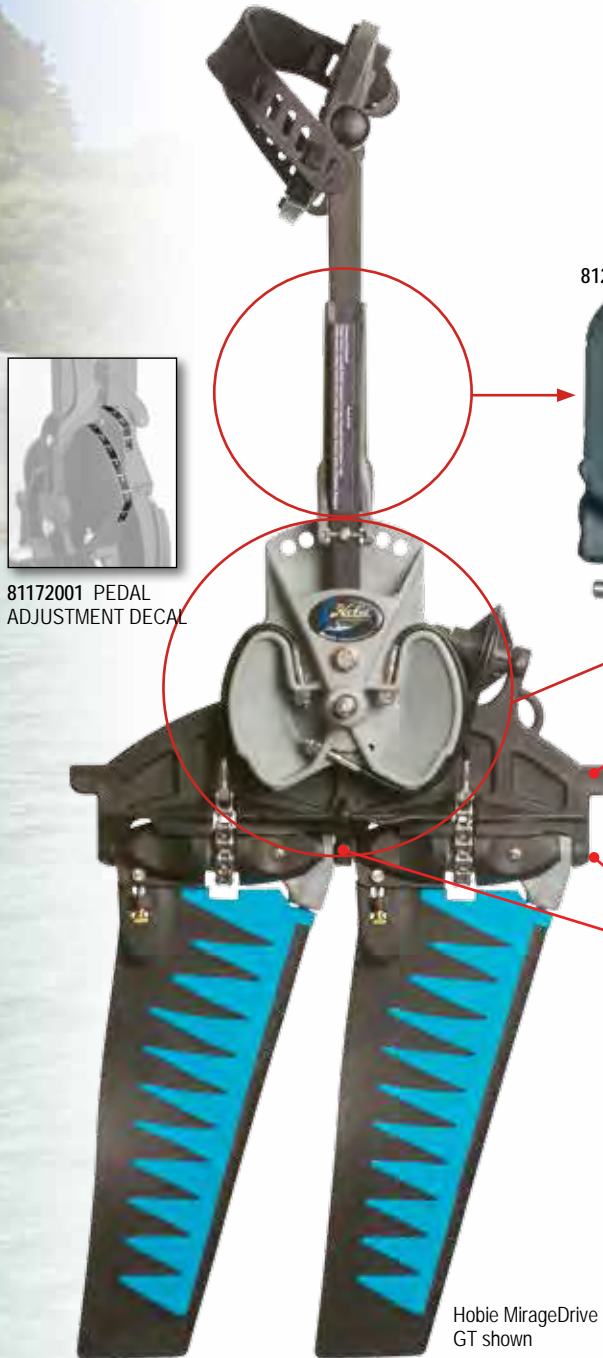

81172001 PEDAL ADJUSTMENT DECAL

Hobie MirageDrive GT shown

- 81236001 PEDAL ADJ ASSY INCLUDES:
- 81240001 PLASTIC HANDLE
 - 81230001 PIN
 - 8031201 SCREW
 - 81242001 SPRING
 - 8034071 ALLEN WRENCH



72020034 PEDAL PAD KIT

- 81222001 PEDAL/CRANK ASSY. (R)
- 81221001 PEDAL/CRANK ASSY. (L)
- 81222011 PEDAL ONLY (R)
- 81221011 PEDAL ONLY (L)
- 81226001 PEDAL STRAP (R)
- 81227001 PEDAL STRAP (L)
- 81222101 CAP - PEDAL
- 8050111 NUT
- 8080541 WASHER

- 81050001 OUTHAUL BLOCK
- 8020041 CLEVIS PIN
- 10860001 LOCK RING

- 81055001 SPROCKET GUARD FWD
- 8031451 SCREW



- 81181001 SPINE NEW 2013

- 81129001 SPROCKET V2 THREADED (W/ FWD GUARD)
- 81127001 SPROCKET GT THREADED (W/ FWD GUARD)



- 81080001 SPROCKET SHAFT
- 53170020 SET SCREW

- COMFORT FIN
- ST FIN
- ST TURBO FIN



- 81190001
- 81193001 (GRY/BLK)
- 81193021 (RED/BLK)
- 81193031 (BLU/BLK)
- 81192001 (GRY/BLK)
- 81192021 (RED/BLK)
- 81192031 (BLU/BLK)

- 81163001 MAST V2 THREADED
- 81198101 MAST / ST TURBO V2 THREADED
- 8000341 LOC-TITE .5ML

UPDATE KIT - V2 SPROCKET
(2 V2 SPROCKETS AND 2 V2 MASTS)
81129022 V2 STANDARD MAST KIT
81129122 V2 TURBO MAST KIT

UPDATE KIT - GT SPROCKET
(2 GT SPROCKETS AND 2 V2 MASTS)
81129023 GT STANDARD MAST KIT
81129123 GTT TURBO MAST KIT



HOBIE MIRAGEDRIVE "V2" / "GT"

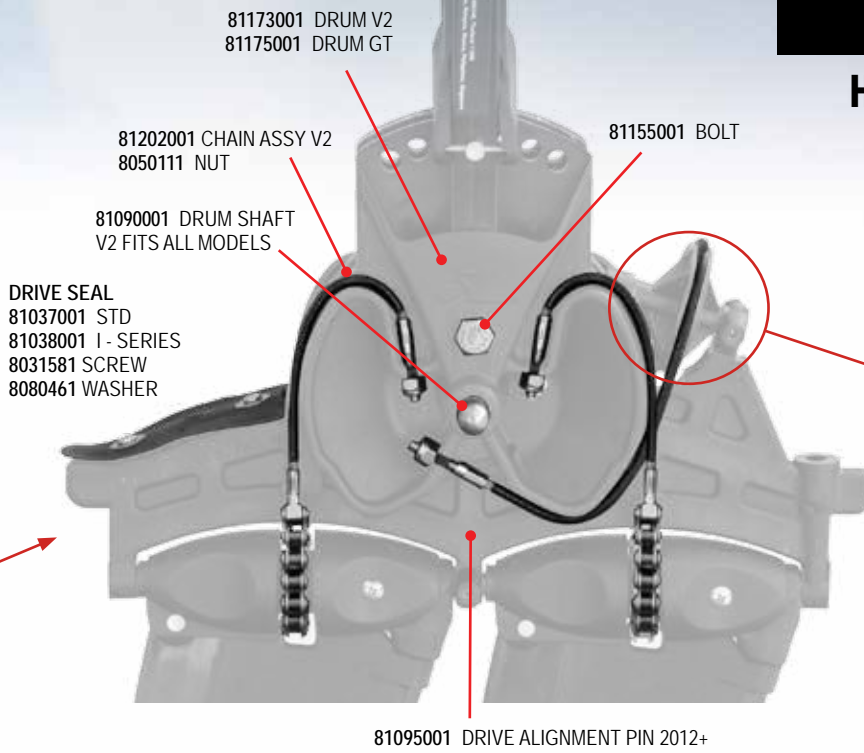

81173001 DRUM V2
81175001 DRUM GT

81202001 CHAIN ASSY V2
8050111 NUT

81155001 BOLT

81090001 DRUM SHAFT
V2 FITS ALL MODELS

DRIVE SEAL
81037001 STD
81038001 I - SERIES
8031581 SCREW
8080461 WASHER

81121001 IDLER PULLEY
81123001 IDLER PULLEY GT

81203001 IDLER CABLE V2 (18.5")

8050111 NUT

53170020 SET SCREW



81110001 PULLEY SHAFT

81095001 DRIVE ALIGNMENT PIN 2012+

HOBIE MIRAGEDRIVE "V1"

Drive with older plastic drum, plastic spine, Sprocket / mast connection is a set-screw

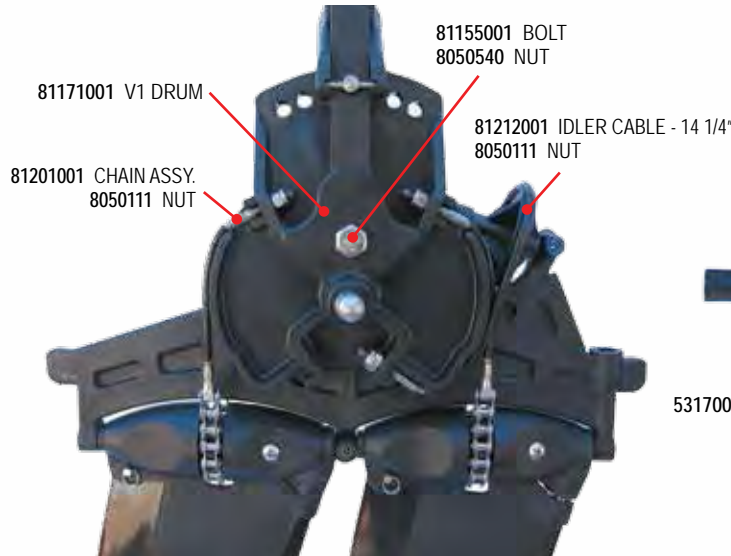

81155001 BOLT
8050540 NUT

81171001 V1 DRUM

81212001 IDLER CABLE - 14 1/4"
8050111 NUT

81201001 CHAIN ASSY.
8050111 NUT

TECH TIP!

MAINTENANCE AND TUNING - Maintenance and tuning information for MirageDrives is available on the Hobie Cat website support area. <http://www.hobiekatyaks.com/support/history/>

Direct link to the support pages for kayaks is here: <http://www.hobiekatyaks.com/support/products/kayaks/>



81128001 V1 SPROCKET

53170020 SET SCREW

V1 Sprocket / mast connection uses a set-screw

UPDATE KIT - V2 SPROCKET
(2 V2 SPROCKETS AND 2 V2 MASTS)
81129022 V2 STANDARD MAST KIT
81129122 V2 TURBO MAST KIT

81160001 OLDER / V1 MAST / STD
81198001 OLDER / V1 MAST / ST TURBO

MIRAGEDRIVE SPARE PARTS KITS

Spare parts kits include a fin, mast, sprocket, chain and appropriate parts for the drive version. Older drives have sprockets and masts that use a set screw connection. V2 drives use threaded sprockets and masts. All in a handy zippered pouch. Don't waste a day on the water when your MirageDrive could be easily repaired. Available for the standard fin drive or a drive with the ST Turbo fins. Standard kit shown.



MIRAGEDRIVE V2 (THREADED MAST)

80010301 KIT V2 COMFORT FIN
80013301 KIT V2 TURBO FIN

MIRAGEDRIVE GT (THREADED MAST)

80010401 GT ST (Bearing Sprocket)
80013401 GT TURBO (Bearing Sprocket)

HOBIE MIRAGEDRIVE— OLDER—

Original drive with aluminum spine, stainless sprocket / mast connection is cotter key. Limited parts available.

81130001 SPROCKET (STAINLESS)
81340001 SPROCKET BUSHING (SS SPKT)
8060111 COTTER KEY (MAST / SS SPKT)
8020061 CLEVIS PIN
10860001 LOCK RING
81211001 IDLER CABLE 14 3/4" (SOLID PULLEY)
81150001 DRUM BUSHING (ALUM DRUM)
81105001 CRANK ARM RIGHT, THREADED